

Mun. ONESTI, jud. BACAU, sc. 1:500  
Nr. cadastral: 64471

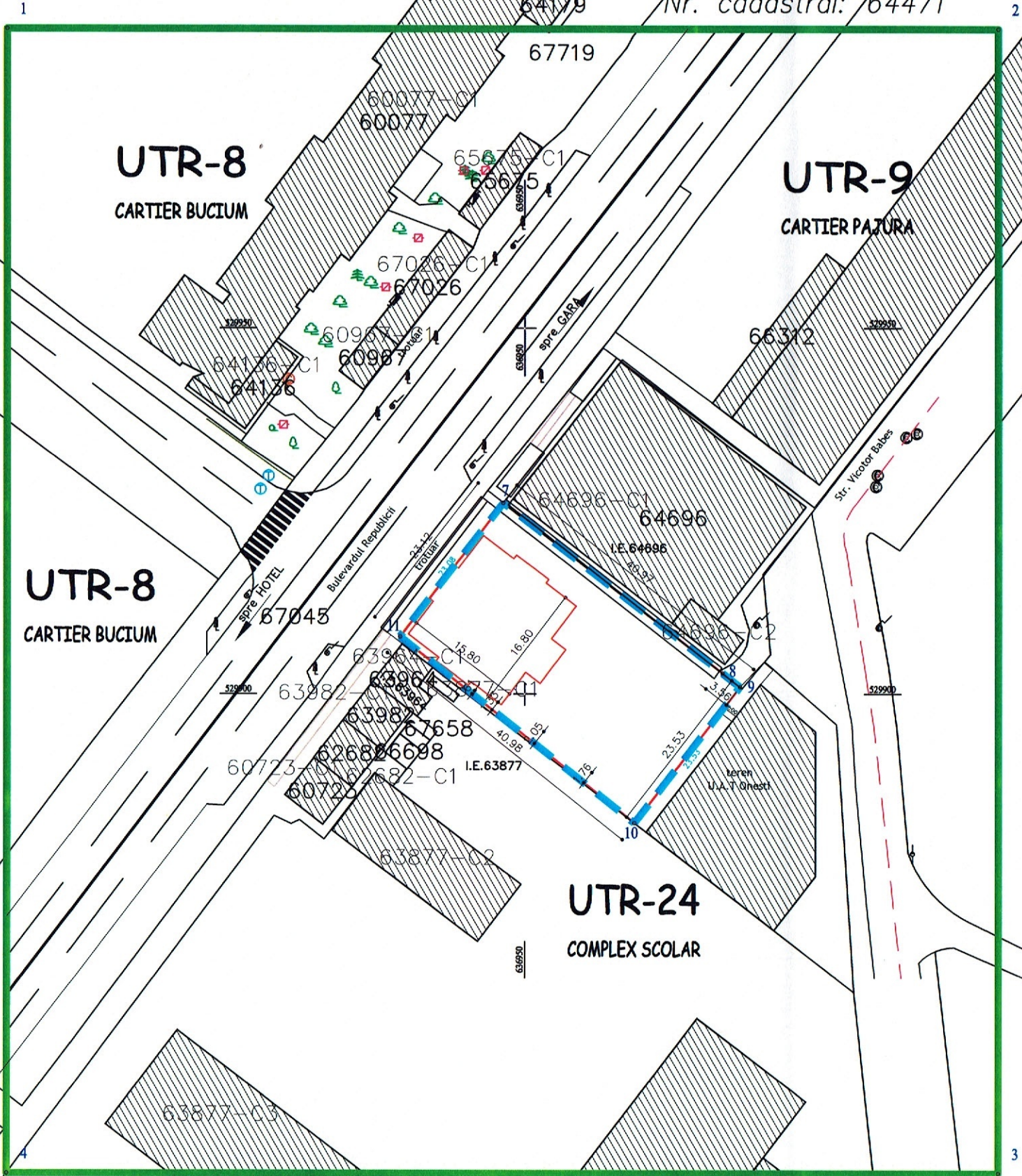

**LIMITA TEREN STUDIAT IN CADRUL P.U.Z.**

Nr. Pct.	X [m]	Y [m]
1	529990.887	636879.254
2	529990.887	637014.715
3	529834.531	637014.715
4	529834.531	636879.254

**LIMITA TEREN PROPRIETATE INITIATOR P.U.Z. TEREN INTRAVILAN**

Nr. Pct.	X [m]	Y [m]
7	529926.100	636947.055
8	529902.815	636977.006
9	529900.955	636979.399
10	529882.381	636964.959
11	529907.825	636932.966

**SC EUROCAD EXPERT SRL**  
 S.C. EUROCAD EXPERT SRL  
 J41771/2012  
 2642 email: eurocadexpert@yahoo.com  
 UROCAD www.eurocadexpert.ro  
 RT SRL Adresa: mun. Onesti, b-dul Republicii,  
 nr. 70, bl. 12, sc. A, ap. 12, jud. Bacau  
 tel: 0834 428 408; 0740 489 636

Denumire proiect: **MODIFICARE TEMA DE PROIECTARE**  
**EXTINDERE SPATIU COMERCIAL SI CONSTRUIRE ANEXA COFETARIE**  
 Adresa: **MUN. ONESTI, B-DUL REPUBLICII, NR.60A, JUD. BACAU**  
 Beneficiar: **SC SELECT COM SA**

Proiectat: Catalin Mihalea  
 Masurat: Catalin Mihalea  
 Calculat: Catalin Mihalea  
 Editat: Catalin Mihalea

Scara: 1:500  
 Denumire plansa: **PLAN TOPOGRAFIC**  
 Data: 04.2024  
 Faza: P.U.Z.  
 A 3